



# Naylors

ESTATE AGENTS CHARTERED SURVEYORS



## Butt Lane

Husbands Bosworth, Lutterworth, LE17 6LN

£200,000

Situated to the south of the A4304 and accessed off a quiet no through road, is the opportunity to purchase two plots for development.

Plot A - A 93m<sup>2</sup> (1000 sq ft) GIA Bungalow with Garage, off road car parking and garden.

Plot B - A 119 m<sup>2</sup> (1248 sq ft) GIA 3 bed house with off road car parking and Garden.

The plots are offered individually or as a whole.

Planning reference 22/00042/FUL

### Viewing

Please contact our Market Harborough Office on 01858 450020 if you wish to arrange a viewing appointment for this property or require further information.



null



null



null



Floor Plan

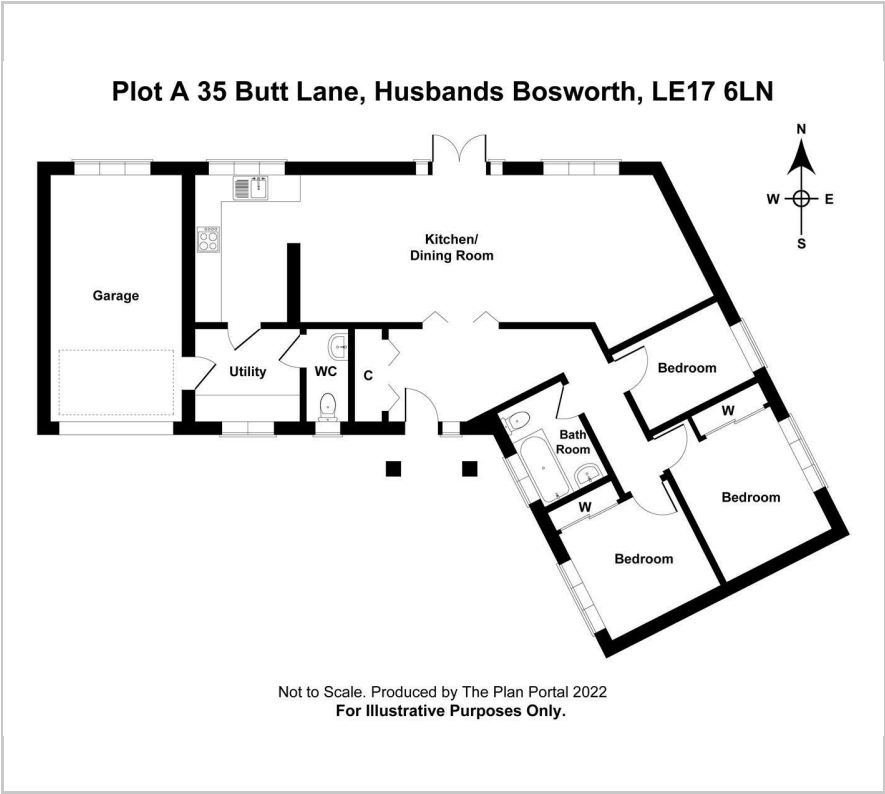

Area Map



Energy Efficiency Graph

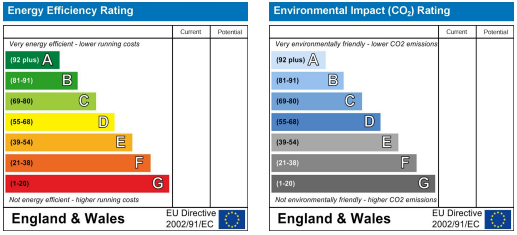

These particulars, whilst believed to be accurate are set out as a general outline only for guidance and do not constitute any part of an offer or contract. Intending purchasers should not rely on them as statements of representation of fact, but must satisfy themselves by inspection or otherwise as to their accuracy. No person in this firm's employment has the authority to make or give any representation or warranty in respect of the property.